



Address: Mullerkade 173, 3024 EH Rotterdam, The Netherlands. Client: Municipality of Rotterdam.  
Completion: 2007. Materials: concrete, rubber (flooring) and metal. Theme: secret garden.



↑ | Top view of "secret garden" and sports area



↑ | "Secret garden" play area  
↓ | Children ride their bikes following the colorful paths

↓ | Children slide in "secret garden" play element

## Public Playground Rotterdam

Rotterdam

Located on the Mullerpier in Rotterdam, the site serves a schoolyard for the primary school nearby and a public square for its vicinity, which includes a home for the elderly, a business center, a theater and housing. The proposal for the playground was set up in cooperation with the school, parents, and neighbors. The demands were more green, shelter and better play areas. The final plan includes a sports area where older children can play competitive games and a smaller square where younger children can play in a diverse way. Around the square is a green hedge, which together with the green rubber underground reflects the theme of "a secret garden". The resulting site challenges children to play in diverse ways, while adults use the square as an outdoor facility of their neighborhood.



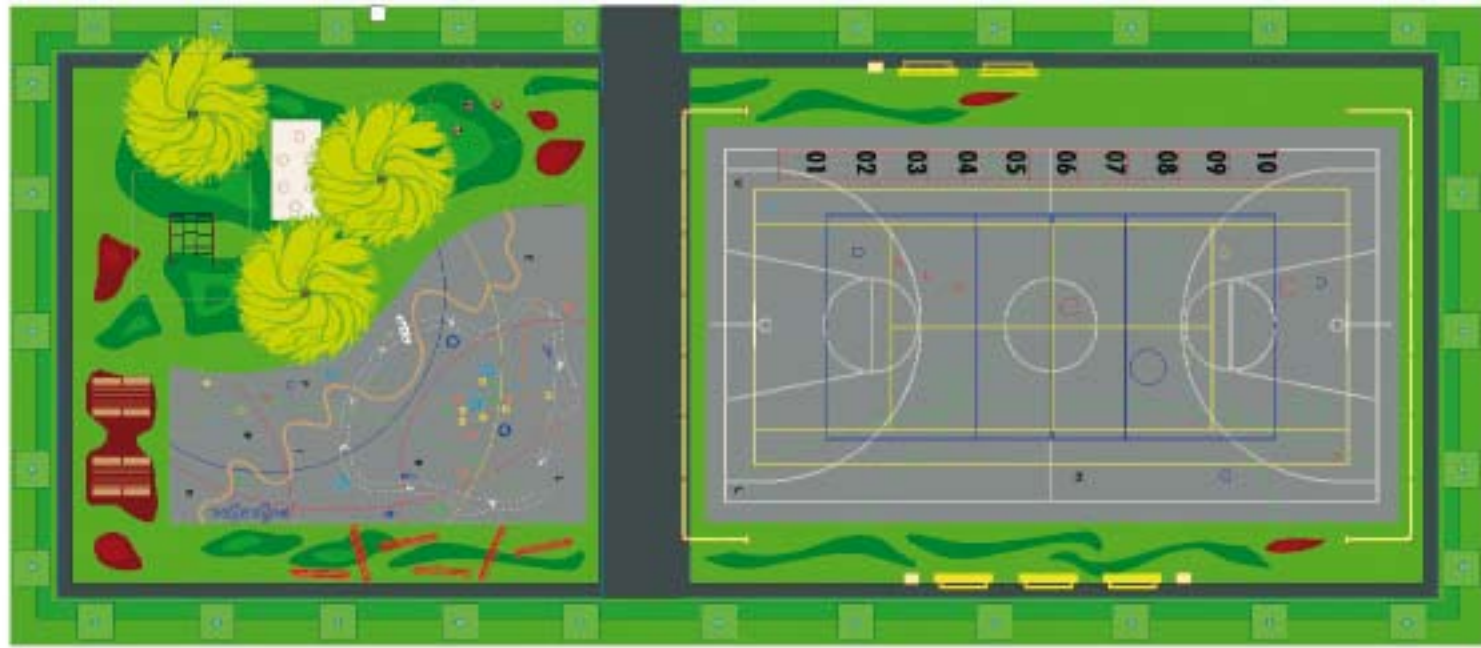

↑ | Site plan  
 ← | Sports courtyard

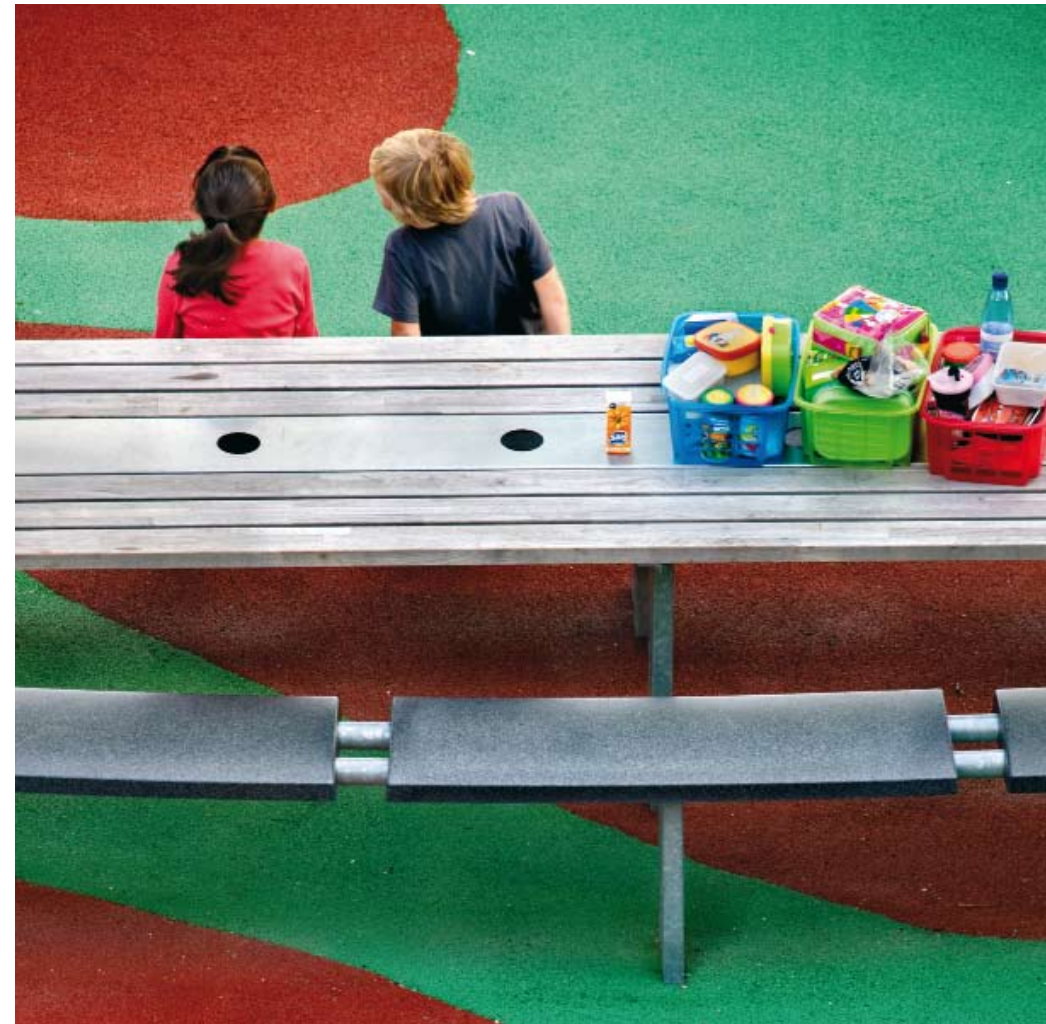

↑ | Bird's-eye view  
 ← | Wooden bench for resting or eating